

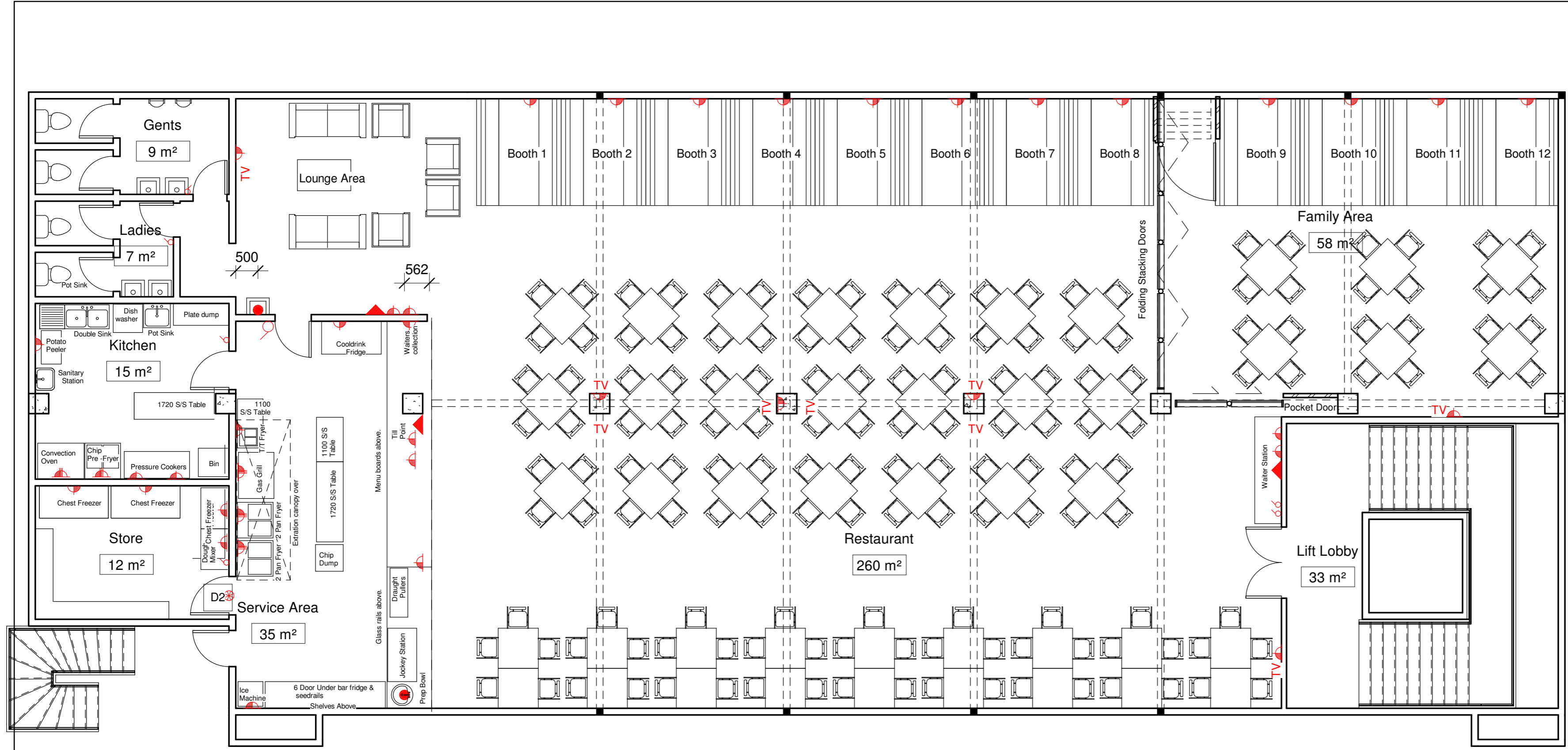

Elisha Annandale
 info@decoridentity.co.za
 www.decoridentity.co.za
 082 777 6600
 VAT Number: 4730267418 CC. Number 2011/031670/23

GENERAL NOTES

- COPYRIGHT**
 - Copyright exists in terms of the Copyright Act, Act No. 98 of 1978.
 - Copyright in these drawings and in the designs which they depict. Any unauthorised copying or use of the design constitutes infringement of copyright and the owner is entitled to sue for damages and claim delivery of the infringing copies and the relevant Certificates of Compliance to be issued to the client upon completion.
 - Copyright infringement includes the sale or distribution of the copy and "COPY" includes the adaptation thereof.
- LAWS AND REGULATIONS**
 - All works and building materials are to comply with National Building Regulations (SANS10400) and Building Standards Act No. 103 of 1977, as amended.
 - All relevant detail, levels and dimensions of any work done, must be checked on site by all contractors. Any discrepancies are to be reported to "Crazy Angel Designs" immediately.
 - All electrical and drainage work is to be executed by registered artisans, and the relevant Certificates of Compliance to be issued to the client upon completion.
- DRAWINGS**
 - Shop drawings must be approved by the client PRIOR to the manufacture of any shopfitting items.
 - Detail drawings must be referred to arrangement drawings.
 - One set of drawings are to be kept on site at all times.
 - All revised drawings are to be clearly marked "REVISION #", and a copy of the revised drawing is to be handed to the contractor.
- DIMENSIONS**
 - Contractors and subcontractors are to check and verify dimensions and detail levels before commencing with any work.
 - Figured dimensions are to be taken in preference to scaled dimensions.
- VARIATIONS, REVISIONS AND AMENDMENTS**
 - The designer is to be notified of any variation by the Project Manager.
 - All relevant detail, levels and dimensions of any work done, must be checked on site by all contractors. Any discrepancies are to be reported to "Crazy Angel Designs" immediately.
- CONTRACTORS AND SUBCONTRACTORS**
 - Contractors must ensure the structural stability of all components of their work and ascertain that the main structure is capable of supporting all loads applied therein.
 - All electrical and drainage work is to be executed by registered artisans, and the relevant Certificates of Compliance to be issued to the client upon completion.
- SHOPFITTED ITEMS**
 - Shopfitted items are to be measured on site and shop drawings are to be approved by the designer AND client PRIOR to material order and manufacture.
- PARTITIONS**
 - All partitions on outside walls are set out from centre lines of columns or window mullions. Any dimensional errors should be accommodated within these parameters.
 - All partitions to be rodent proofed and have a minimum of 30 minute fire rating.
 - All partitions to comply to SANS10400.



1 Third Floor - Electrical Plan
 1 : 75

Electrical Legend		
	Distribution Board	1
	15 A Double Plug Point	39
	3 Phase plug point	7
	15 A Double Plug Point - Recessed Floor Pedestal	2
	Data connection	4
	Data, voice and power cluster. Mounted in drywall partitions.	0
	Corporate Connection. Mounted in drywall partitions.	0
	Data, voice and power cluster. Mounted in power skirting.	0
	Access controlled door.	1
	Double channel power skirting.	12 r/m
	Core drill through slab. All core drills to be signed off by an engineer.	2
	Floor to ceiling power pole.	0
	Single light switch.	7
	Two way light switch.	0
	Television point.	9

No.	Description	Date
1	Third Floor - Family Lounge	04/02/2019
3	Beauty Salon on Second Floor	11/03/2019
4	Revised Grocery and bar	07/06/2019

Copyright of Decor Identity.
 All rights reserved.

Bargains Centre

Third Floor - Electrical Plan

Project number	B-01
Date	07/12/2018
Drawn by	Author
Checked by	Checker
B-03-04	
Scale	As indicated on A2

07/09/2019 8:46:54 AM